

BLACK TOOTH

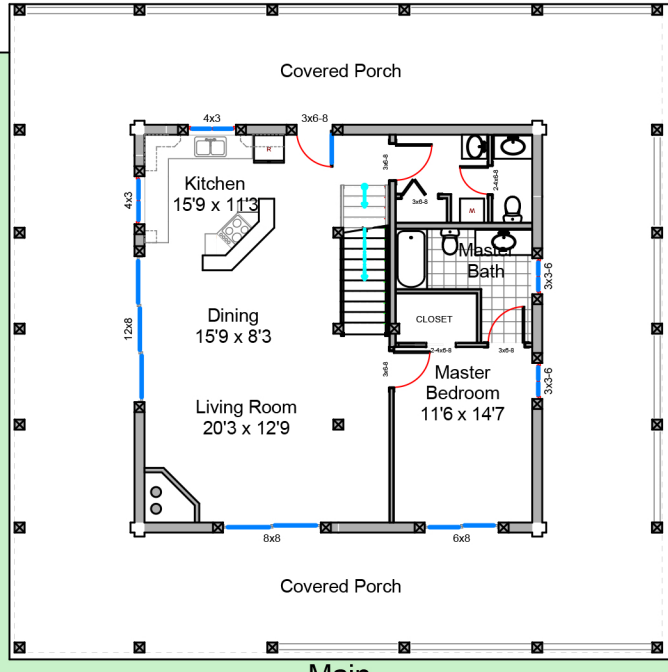

This one bedroom, 1 1/2 bath floor plan has a large open floor plan from the kitchen, through the dining room and into the living area. The master bedroom has a walk-in closet, large bathroom, and a sliding glass door onto the covered porch. The upstairs is an open 450 square foot loft with an additional 160 square foot balcony. This loft can be converted to a second bedroom. The lower level boasts an impressive 1720 square foot wraparound covered porch.



Beds 2	Main Level 1,156 sq ft
Baths 1.5	Upper Level 450 sq ft
	Porches 1,862 sq ft
	Total Usable 3,468 sq ft

